

#### STEP 1:

MASK OFF AREAS WHERE THE LAVENDER RIBBON INTERSECTS WITH TEAL RIBBON. USE A TAPE SIMILAR TO WHAT I HAVE SHOWN

#### STEP 2:

USE ACETONE TO WIPE OFF PAINTED AREA, DAMPEN A MICRO-FIBER TOWEL TO WIPE OFF PAINTED AREA. USE Q-TIP SWAB DAMPENED WITH ACETONE TO CLEAN OUT SMALL AND TIGHT AREAS. *BE EXTREMELY CAREFUL NOT TO SPILL ANY ACETONE ON TEAL PAINTED AREAS.*

#### STEP 3:

MIX A SOLUTION OF WATER AND A COUPLE DROPS OF DISH SOAP. NOT TOO SOAPY. WIPE AREAS CLEAN. APPLY PROVIDED PAINT MASK TO PANEL. SEE ORDER IN DRAWING FOR PLACEMENT. USE A SQUEEGEE OR PLASTIC CREDIT CARD, PLASTIC PUTTY KNIFE. APPLY EXTRA PRESSURE WHERE MASK MEET EDGE OF AREA TO BE PAINTED.

#### STEP 4:

APPLY 2 LIGHT COATS OF CLEAR KRYLON PAINT. 5 MINUTES BETWEEN COATS. LET DRY FOR 30 MINUTES.

#### STEP 5:

SET UP MINI SPRAY GUN OR AIRBRUSH FOR PAINTING, RUN WATER OR CLEANER THROUGH GUN.

ADJUST SPRAY FAN SO THAT IT HAS A SMALL FAN SPRAY PATTERN.

PAINT IS PRE-REDUCED SHOULD BE SPRAY READY. STRAIN PAINT BEFORE POURING IN PAINT GUN.

A CLEANING SOLUTION CAN BE MADE BY MIXING 6 OZ WATER WITH 1 OZ WINDEX GLASS CLEANER.

## STEP 6

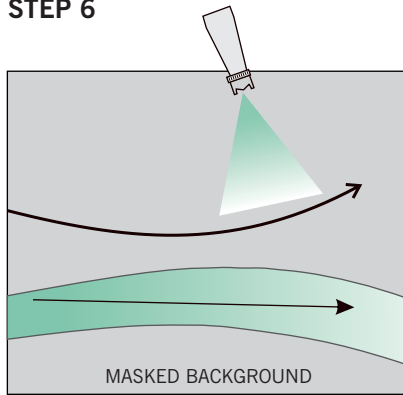

TEAL COLOR  
ARROWS ARE DIRECTION OF GUN WHILE PAINTING.  
COLOR SHOULD BE APPLIED LIGHTLY TO AVOID PAINT COLLECTING AS DROPLETS ON GLASS.  
MAY TAKE 3-4 LIGHT COATS TO ACHIEVE COVERAGE. HAIR DRYER CAN BE USED TO SPEED UP DRYING.  
EACH COAT SHOULD AIR DRY IN ABOUT 2-3 MINUTES.  
RIBBON SECTIONS SHOULD BE PAINTED AS SHOWN WITH FADE FROM LIGHT TO DARK.

TEAL PAINT WILL BE REDUCED READY TO PAINT, REDUCER AND CLEAR TRANSPARENT BASE WILL ALSO BE INCLUDED TO ADJUST PAINT REDUCTION AND TRANSPARENCY AS NEEDED.

## STEP 7

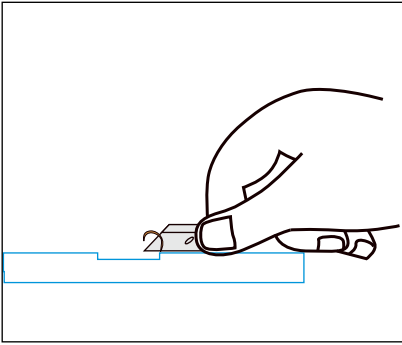

TO SMOOTH TRANSITION FROM DARK TO LIGHT.  
LET DRY FOR 30 MINUTES AND APPLY 2 MEDIUM COATS OF CLEAR TO SEAL PAINT.  
UN MASK AFTER 30 MINUTES. PULL MASK AWAY FROM PAINTED AREA SLOWLY AT A SHARP RIGHT ANGLE TO AVOID LIFTING UP PAINT FROM EDGE.  
CLEAN EDGE WHERE MASK AND PAINT MEET WITH A NEW SHARP SINGLE EDGE RAZOR.

THESE PAINT GUNS CAN BE PURCHASED AT ANY LOCAL  
HARBOR FREIGHT STORE



\$15.00

[https://www.harborfreight.com/adjustable-detail-spray-gun-92126.html?utm\\_source=go&utm\\_medium=social&utm\\_campaign=shortener&cid=go\\_social](https://www.harborfreight.com/adjustable-detail-spray-gun-92126.html?utm_source=go&utm_medium=social&utm_campaign=shortener&cid=go_social)



\$20.00

<https://www.harborfreight.com/deluxe-airbrush-kit-95810.html>